

Notes:

1. Do not scale drawing.
2. Right hand shown.
3. Suitable reinforcing by others.
4. Pivots drilled for 1/4-20 x 5/8 FHMS or #14 x 1-1/2 FHWS.
5. When jamb portion is installed on top of threshold allow for threshold height when preparing frame and door mortise depth.
6. All dimensions are in inches (mm).

**Pivot Set
3/4" Offset, Handed**

RIXSON®
ASSA ABLOY

www.rixson.com

NUMBER

IS-195

DATE

07-09

195 Pivot Set

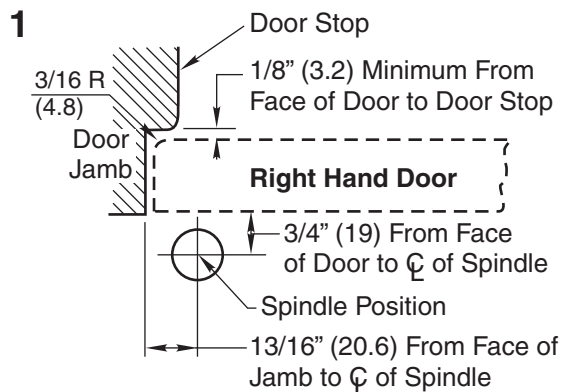

1. Install Pivot

- Measure 13/16" (20.6) out from door jamb.
- Allow 1/8" (3.2) min. clearance from door stop to door face. Measure door thickness. Add 3/4" (19).
- Where lines meet determines center line of closer.

2. Set Pivot Set

- Mortise jamb to receive jamb leaf as shown on reverse side.
- Care must be exercised to see that pivot end of jamb leaf is level. Place levels as per illustration.

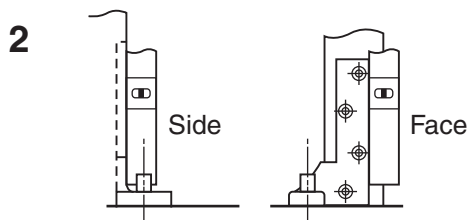

3. Install Top Pivot & Pivot Arm

- Install top pivot in door per template.
- Install top pivot in frame per template.
- Install arm in door per template.
- Center line of pivot should line up with center line of spindle. Use plumb line as illustrated.
- If side jamb pivot is used, see required template.

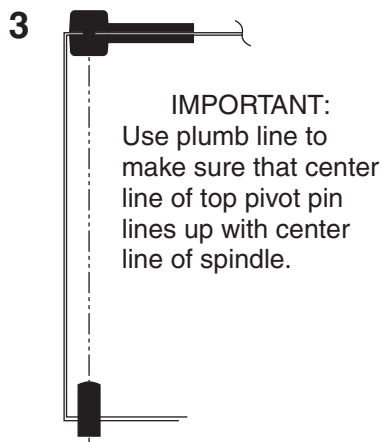

4. Hang Door

- Set door on pivot set spindle.
- Push Item 1 "top pivot pin" into place. Attach "cap" Item 2.
- If door drags at floor (or threshold, if used) loosen arm locking screw and raise door to desired clearance and insert one or more 1/16" (1.6) shims. Retighten arm locking screw securely.
- Put arm cap on arm and secure tightly with cap screw furnished.

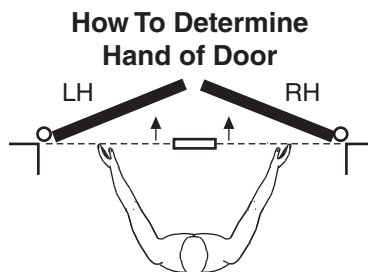
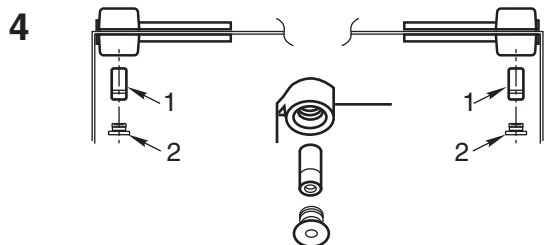

Face a door swinging open away from you.
 If it opens to the right, it is right hand. If it opens to the left, it is left hand.

Pivot Set
3/4" Offset, Handed

RIXSON®
ASSA ABLOY

www.rixson.com

NUMBER

IS-195

DATE

07-09